

INSTRUCTION SHEET

Bulletin 511 Type "S" 7" AC Brake

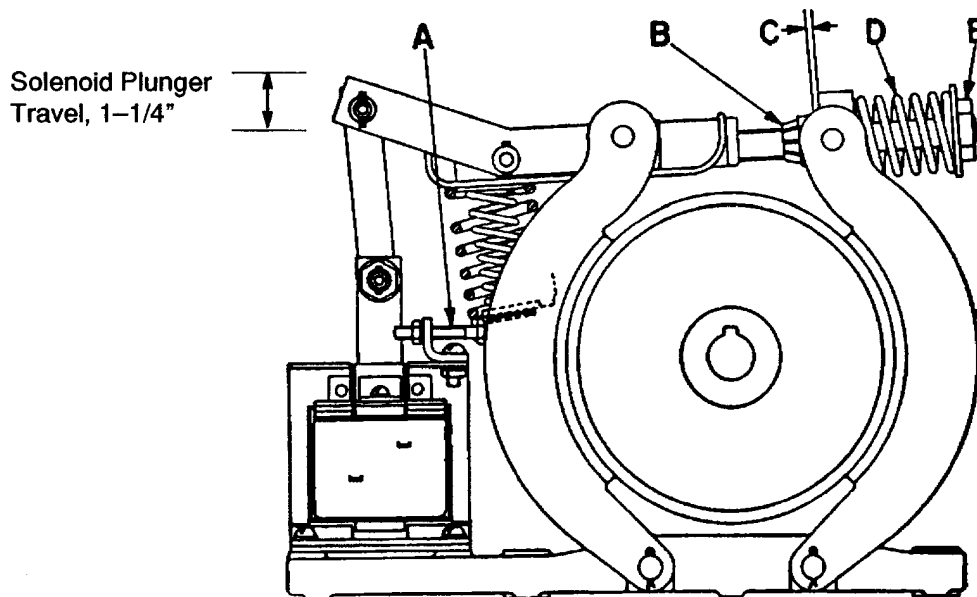

INSTRUCTIONS

1) **Mounting** – (Refer to Dimension Drawing) – Push the solenoid plunger down to separate the brake shoes. The brake can then be slid over the wheel. Release the plunger to apply the shoes against the wheel. Insert shims between the mounting stand and the brake base until the brake is settling solid on the stand. Then fasten the brake to the stand with mounting screws or bolts. NOTE: These brakes **should** be mounted in a **horizontal position** with the base below the solenoid and shoes. Side or vertical mounting can result in accelerated wear of the solenoid.

2) **Equalize Shoe Clearance** – With the brake released (solenoid plunger down), equalize the clearance between the shoes and wheel with screw "A". Be sure to tighten the lock nut when the adjustment is completed.

3) **Adjustment** – The brake is adjusted at the factory to provide the rated torque shown on the nameplate. If the load is stopped too rapidly and a lower torque is desired, increase the compressed length of spring "D" by holding nut "B" to prevent rotation while turning nut "E" counter-clockwise. When the desired torque is obtained, be sure that the clearance "C" is 1/64" and travel of the solenoid plunger should be 1-1/4".

4) **Readjustment for Lining Wear** – As the lining wears, the clearance "C" decreases. Never permit this clearance to become zero because complete loss of torque will result. When the clearance "C" becomes low, again adjust to 1/64" by turning screw "E". No change in torque will result from this adjustment. Brake linings should be renewed before the lining wears down to approximately 1/4", so that the groove pins do not contact the brake wheel surface.

Size of Brake	Torque Rating	Compressed Length of Spring "D"
7"	50 lb-ft	2.31
	75 lb-ft	2.05
	85 lb-ft	2.29
	110 lb-ft	2.17

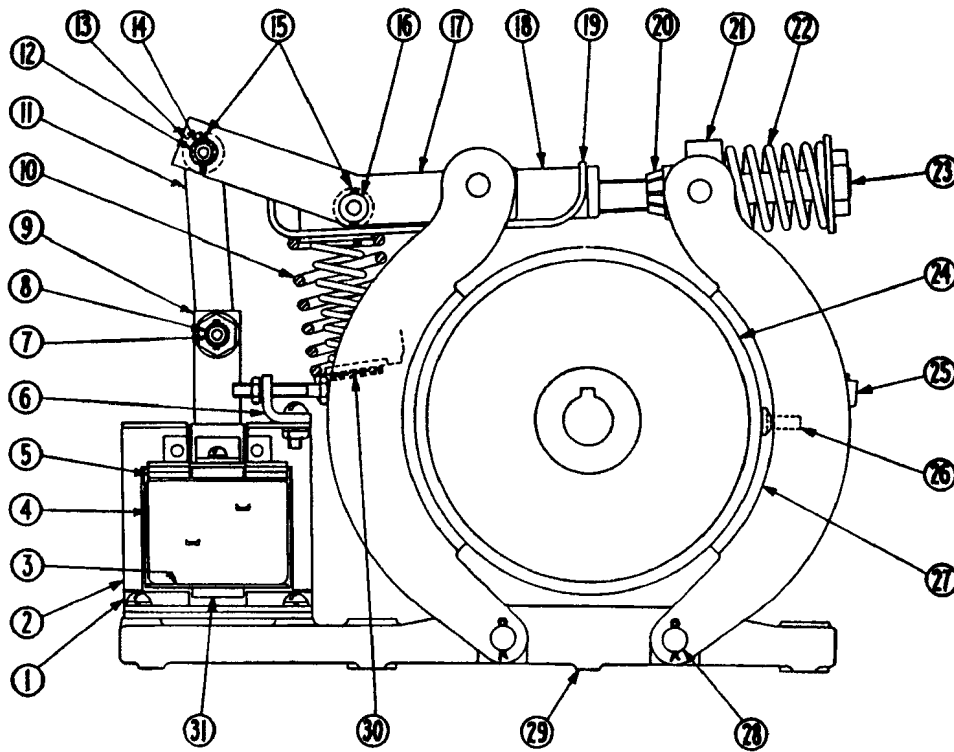

RENEWAL PARTS – Information Required

Parts **CANNOT** be sent promptly unless you include the **FOLLOWING** with your order: **PUBLICATION NUMBER, ITEM NUMBER, PART NUMBER, DESCRIPTION, AND COMPLETE NAMEPLATE DATA ON THE BRAKE**

Item Number	Description of Part	Number Required	Part Number
1	Solenoid without coil (includes Items 2, 3, 4, 5, 6, 9, and 31)	1	88-1342-11
2	Solenoid frame	1	17-476
3	Coil washer	2	16-254
◆ 4	Coil (give number on coil)	1	—
5	Coil spring	2	69-273
6	Bracket	1	79-415
7	Pin	1	13-7700
	Spring pin	2	13-3186
	5/16 washer	2	916-801Z
8	Bearing	2	20-102-2
◆ 9	Plunger complete (includes Items 7 and 8)	1	51-93-15
◆ 10	Solenoid spring		
	Outer spring (all brakes)	1	69-296
	Inner spring (85-110 lb-ft only)	1	69-2910
11	Link	1	51-1151
12	Neoprene sleeve	1	18-615-15
13	Spacer	2	29-1440-2
14	Pin	1	13-317-10
15	Spring pin (1/8 x 3/4 long)	4	13-3187-2
16	Pin	1	13-1145-13
	Washer	2	916-1081Z
17	Lever	2	24-2674-2
18	Adjusting stud nut	1	15-776
19	Spring gland	1	49-3029
20	Jam nut	2	15-175
	Washer	1	916-1281Z
21	Block	1	17-516
◆ 22	Torque spring		
	50-75 lb-ft torque	1	69-297
	85-110 lb-ft torque	1	—
23	Adjusting screw	1	11-302-2
◆ 24	Brake wheel (see below)	1	69-761
25	Shoe complete	2	48-1200-3
26	Groove pin	12	13-4762
27	Lining (for cast iron shoes)	2	48-1199-2
28	Base pin	2	13-482
29	Base	1	17-10476
30	Shim washer		16-319
◆ 31	Plunger guide	2	54-300-2
◆ 32	Set of linings for repairs (includes Items 26 and 27)	1	6-166-5

- ◆ We recommend that these items be stocked. The quantity to be stocked will depend upon the total number in use.
- Give Catalog "H" number when stamped on the wheel, or if this number does not appear on the wheel, give complete brake nameplate data and bore and keyway dimensions.